

Paratransit Cutaway Specifications

Base Model Starcraft Allstar 7.3L V8 Gas 158" WB 11,500 GVWR

Vehicle Length 23'

Rear Lift Position

Two Wheelchair Positions

Total Passenger Count 12

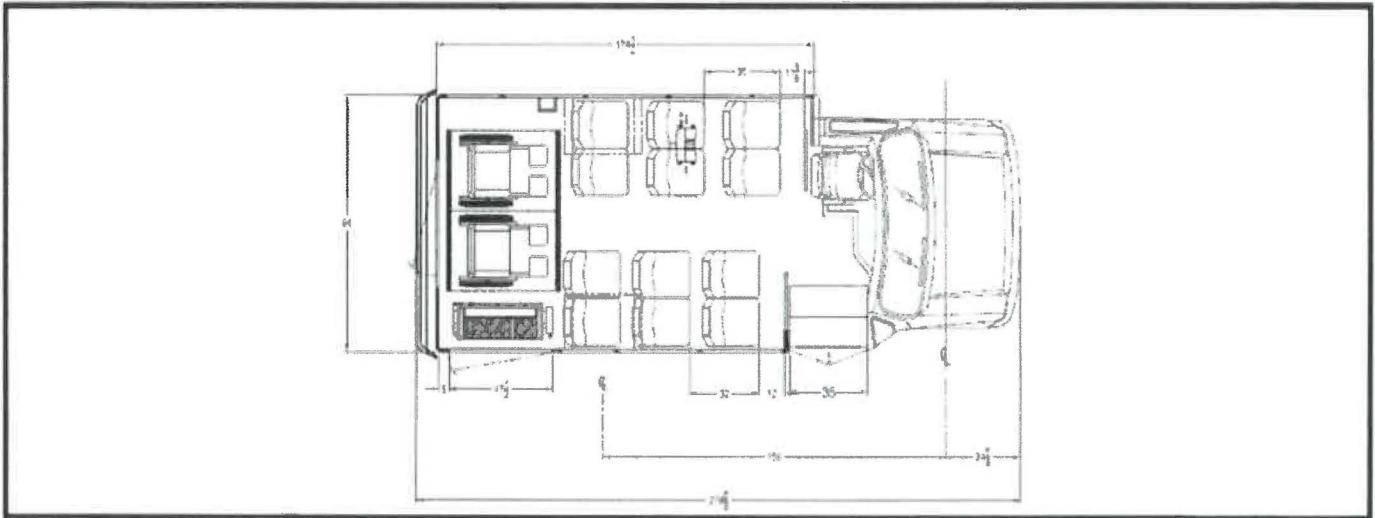



Base Model Features

Chassis

Ford E-350 chassis - 12,500 GVWR
7.3L V8 gasoline engine
6-Speed TorqShift Automatic Transmission
Twin I-Beam IFS front axle - 5,000 lbs.
Full-floating, Dana 10.5" rear axle - 8,500 lbs.
Power-assisted hydraulic front & rear disc brakes
4-wheel anti-lock brake system
210 Amp Alternator
Dual, maintenance-free batteries
40 Gallon Fuel Tank
Power steering with tilt wheel
HD gas shock absorbers
Front & rear stabilizer bars
LT225/75Rx16E All Season Tires

Spare Tire & Wheel

Dual rear wheels

OEM AM/FM/BT Radio

Heavy Duty Driver Side Running Board

OEM chassis dash heater, A/C, and defroster
Chrome front bumper

Body

Starcraft Allstar 22ft
Pre-painted white galvanized steel sidewalls and skirts
Fiberglass front and rear caps
One-piece seamless FRP roof
55K BTU rear A/C system- Single Compressor Tie In
Gerflor Sirius Graphite flooring (black)
Yellow step nosing
Rear mud flaps
Rear Door with 2 Windows
40K BTU rear heater
Standard Battery Box with Stainless Tray
Electrically actuated passenger entry door with full length glass
Mid High rigid passenger seats- 12 Passenger **w/standard lap belts**
Ceiling Grab Rail- Street Side
Dual Grab Rails Parallel to Entrance- Both Sides
Stanchion and Modesty Panel behind driver
Freedman Shield Driver Seat

ADA

Single wheelchair door with spring tensioner door stay
Rear wheelchair lift (aft of rear axle)
Braun NL-919-2 wheelchair lift (800# capacity)
ADA interlock/fast idle
ADA Interior Exterior LED Lights
Two (2) Q'Straint QRT-MAX Slide 'N Click wheelchair securements with combo lap/shoulder belt

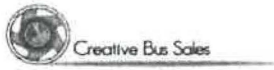

Base Model Features

Safety

5 lb. fire extinguisher

Body Fluid Kit

First aid kit- 16 unit

Emergency triangle kit

Backup alarm

Backup camera system with 7" monitor